

TALL UNIT IS FLOWN INTO PLACE

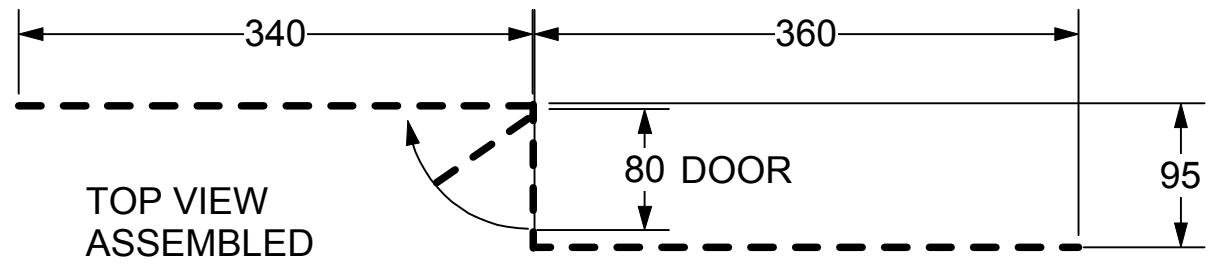

TWO SMALL UNITS LOCK INTO PLATFORM

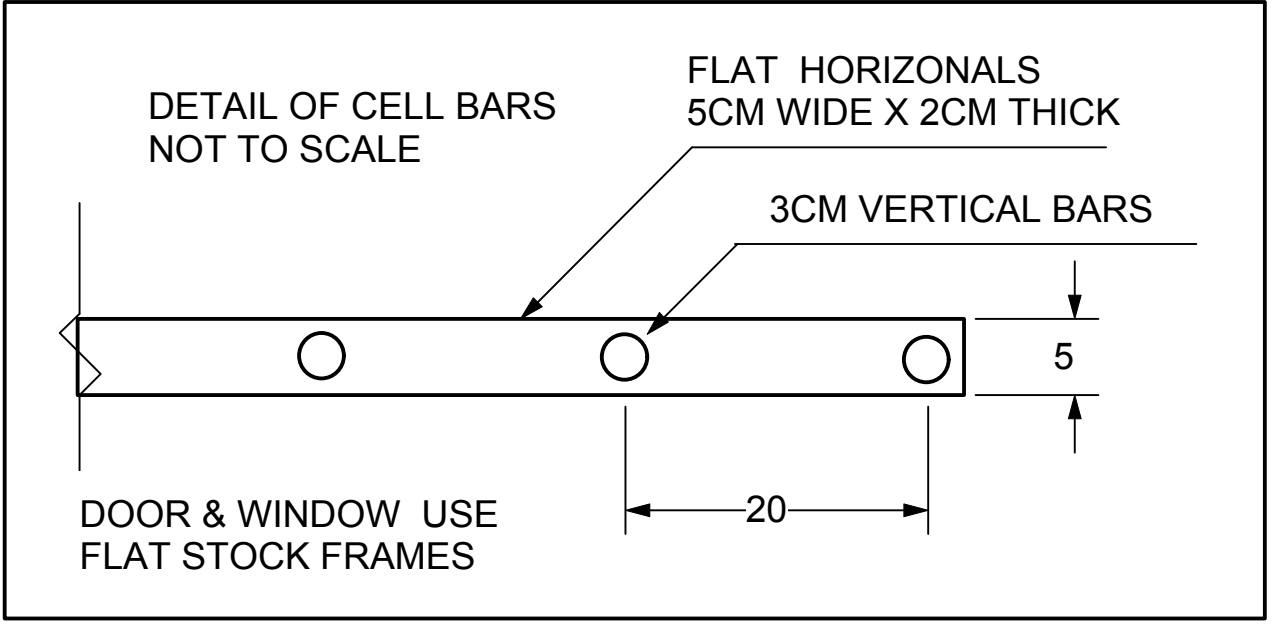
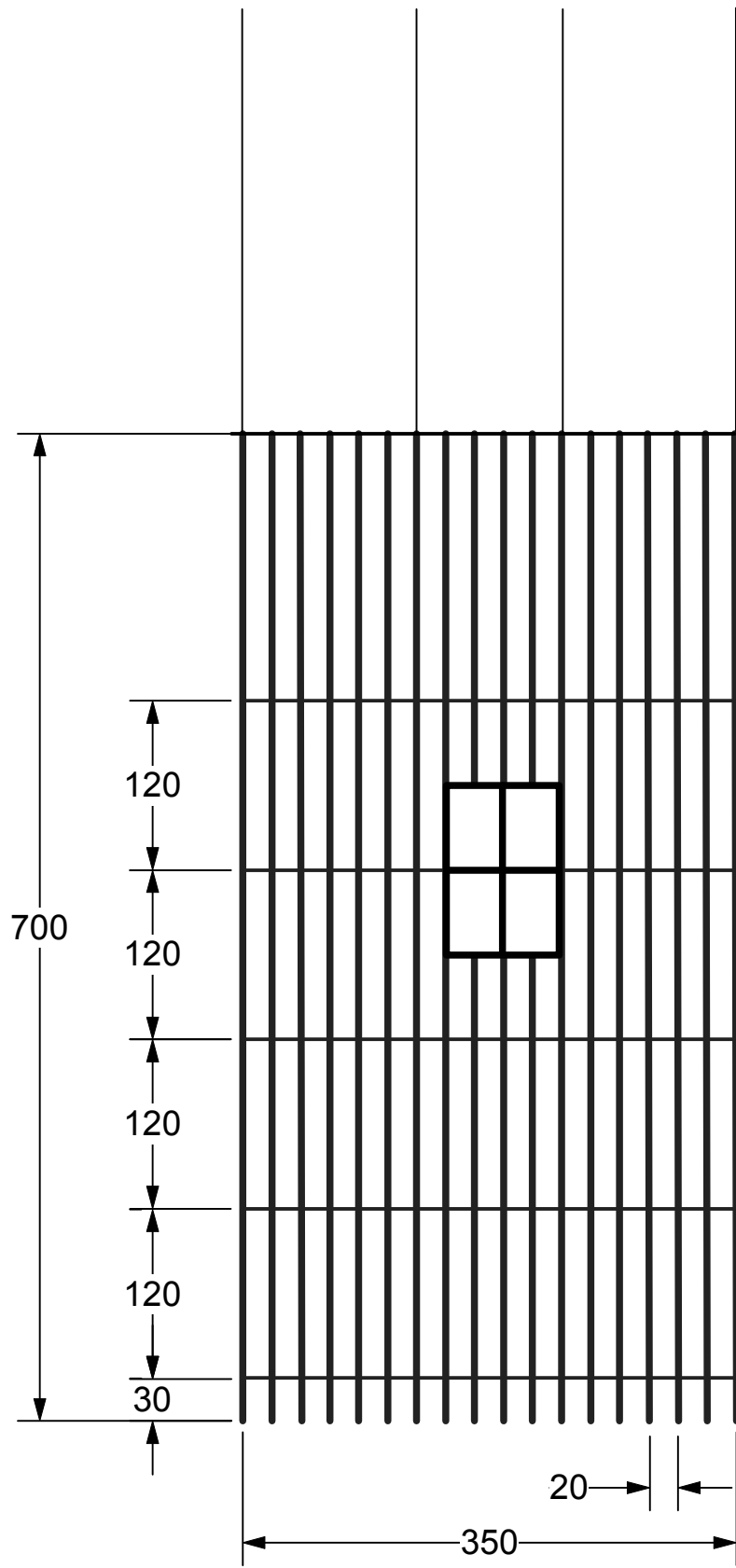
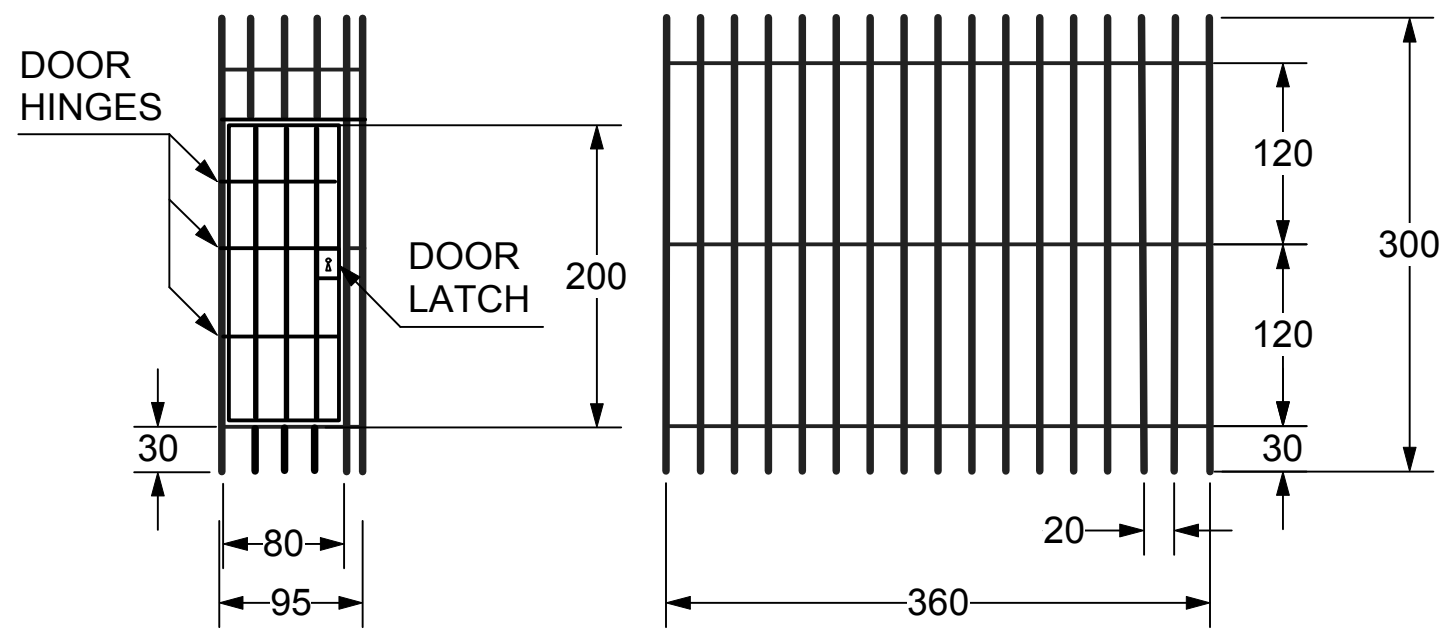

FRONT VIEWS

PRISON CELL - ACT 4
 DATE: 28 SEPTEMBER 2015
 SCALE: 1:50 (EXCEPT AS NOTED)
 PLATE 12

THE CRUCIBLE BY ARTHUR MILLER
 AMERICAN UNIVERSITY IN CAIRO -- MALAK GABR THEATRE
 DIRECTOR: FRANK BRADLEY
 DESIGN: STANCIL CAMPBELL